



**YASHIMA**  
**NBV Co.,LTD**



**EMT Conduit Standard Style 45**

---

**EMT Conduit Thin Style 45**

---

**IMC Conduit 45**

---

**RMC Conduit 46**

---

**EMT ELBOW 90° 46**

---

**IMC ELBOW 90° 46**

---

### TABLE OF PRODUCT STANDARD

	Outside Diameter	Inside Diameter	Wall Thickness	Length
1/2"	17.93mm	15.80mm	1.07mm	3050mm
3/4"	23.42mm	20.93mm	1.25mm	3050mm
1"	29.54mm	26.64mm	1.45mm	3050mm
1 1/4"	38.35mm	35.05mm	1.65mm	3050mm
1 1/2"	44.20mm	40.89mm	1.65mm	3050mm
2"	55.80mm	52.50mm	1.65mm	3050mm
2 1/2"	73.03mm	69.37mm	1.83mm	3050mm
3"	88.90mm	85.24mm	1.83mm	3050mm
3 1/2"	101.60mm	97.38mm	2.11mm	3050mm
4"	114.30mm	110.08mm	2.11mm	3050mm

### EMT CONDUIT STANDARD STYLE



### EMT CONDUIT THIN STYLE



### TABLE OF PRODUCT STANDARD

	Outside Diameter	Inside Diameter	Wall Thickness	Length
1/2"	17.93mm	15.80mm	1.07mm	3050mm
3/4"	23.42mm	20.93mm	1.25mm	3050mm
1"	29.54mm	26.64mm	1.45mm	3050mm
1 1/4"	38.35mm	35.05mm	1.65mm	3050mm
1 1/2"	44.20mm	40.89mm	1.65mm	3050mm
2"	55.80mm	52.50mm	1.65mm	3050mm

### TABLE OF PRODUCT STANDARD

	Outside Diameter	Inside Diameter	Wall Thickness	Length
1/2"	20.97mm	16.76mm	1.97mm	3050mm
3/4"	26.26mm	22.07mm	2.10mm	3050mm
1"	32.77mm	28.07mm	2.35mm	3050mm
1 1/4"	41.59mm	36.77mm	2.41mm	3050mm
1 1/2"	47.82mm	42.74mm	2.54mm	3050mm
2"	59.93mm	54.60mm	2.67mm	3050mm
2 1/2"	72.57mm	64.95mm	3.81mm	3050mm
3"	88.29mm	80.67mm	3.81mm	3050mm
3 1/2"	100.86mm	93.24mm	3.81mm	3050mm
4"	113.44mm	105.82mm	3.81mm	3050mm

### IMC CONDUIT



PULL BOX

CABLE DUCT

CABLE LADDER

STEEL CONDUIT

FLEXIBLE CONDUIT

CONDUIT FITTINGS

FLEXIBLE CONDUIT FITTINGS

STEEL BOX

CONDUIT BODIES

PLASTIC FITTINGS

PULICA FITTINGS

## RMC CONDUIT



### TABLE OF PRODUCT STANDARD

	Outside Diameter	Inside Diameter	Wall Thickness	Length
1/2"	21.34mm	16.05mm	2.64mm	3050mm
3/4"	26.67mm	21.23mm	2.72mm	3050mm
1"	33.40mm	27.00mm	3.20mm	3050mm
1 1/4"	42.16mm	35.41mm	3.38mm	3050mm
1 1/2"	48.26mm	41.25mm	3.51mm	3050mm
2"	60.33mm	52.91mm	3.71mm	3050mm
2 1/2"	73.03mm	63.22mm	4.90mm	3050mm
3"	88.90mm	78.49mm	5.21mm	3050mm
3 1/2"	101.60mm	90.68mm	5.46mm	3050mm
4"	114.30mm	102.87mm	5.72mm	3050mm

### TABLE OF PRODUCT STANDARD

Cat#	Size
EEB90-50	1/2"
EEB90-75	3/4"
EEB90-100	1"
EEB90-125	1 1/4"
EEB90-150	1 1/2"
EEB90-200	2"
EEB90-250	2 1/2"
EEB90-300	3"
EEB90-400	4"

## EMT ELBOW 90°



## IMC ELBOW 90°



### TABLE OF PRODUCT STANDARD

Cat#	Size
IEB90-50	1/2"
IEB90-75	3/4"
IEB90-100	1"
IEB90-125	1 1/4"
IEB90-150	1 1/2"
IEB90-200	2"

PULL BOX

CABLE DUCT

CABLE LADDER

STEEL CONDUIT

FLEXIBLE CONDUIT

CONDUIT FITTINGS

FLEXIBLE CONDUIT FITTINGS

STEEL BOX

CONDUIT BODIES

PLASTIC FITTINGS

PULICA FITTINGS





**YASHIMA  
NBV Co., LTD**

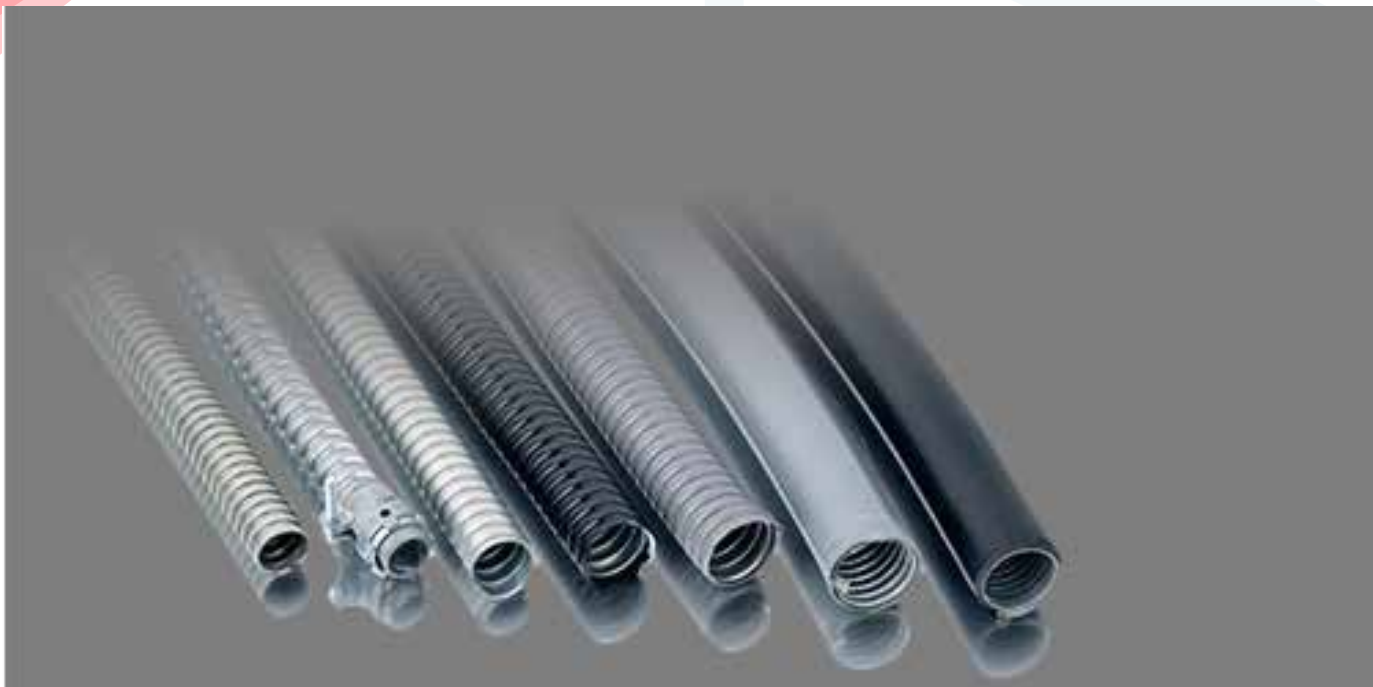

Galvanized Flexible Conduit **48**

Galvanized Flexible Conduit UL Standard **48**

PVC Coated Corrugated Conduit **48**

Stainless Steel **49**

Pulica Tube LV-5 **49**

Liquid Tide Conduit **49**

## Galvanized Flexible Conduit (P3 Single Locking)



## TABLE OF PRODUCT STANDARD

SIZE	Outside Diameter		Inside Diameter		Bending Radius (m)	Length
	MIN	MAX	MIN	MAX		
1/4"	9.70	10.20	11.50	14.00	22.5	100
3/8"	12.30	12.70	15.60	6.00	30	100
1/2"	15.80	16.20	19.30	19.80	40	50
3/4"	20.70	21.10	24.30	24.90	50	50
1 1/4"	26.20	26.80	30.20	30.70	52.5	50
1 1/2"	34.70	35.30	39.00	39.90	80	30
2 1/2"	40.00	40.70	45.40	46.80	90	25
2"	50.80	51.60	57.00	57.60	95	20
2 1/2"	63.00	63.60	70.20	70.80	140	10
3"	78.00	78.70	85.20	85.90	160	10
4"	101.60	102.60	108.50	109.50	190	10

## TABLE OF PRODUCT STANDARD

SIZE	Outside Diameter		Inside Diameter		Bending Radius (m)	Length
	MIN	MAX	MIN	MAX		
1/2"	11.88	16.36	21.84	23.37	85	100
3/4"	20.62	21.21	26.54	28.07	100	100
1"	25.40	26.42	33.02	35.04	180	50
1 1/4"	31.75	33.02	39.37	41.40	180	30
1 1/2"	38.10	40.01	44.99	49.23	220	50
2"	50.80	52.83	59.69	62.23	290	30
2 1/2"	63.50	63.80	72.64	77.72	330	25
3"	76.20	76.30	85.34	90.42	480	20
4"	101.60	101.80	110.74	115.82	600	10

## Galvanized Flexible Conduit UL Standard (P4 Inter Locking)



## PVC Coated Corrugated Conduit (JSH Type)

## TABLE OF PRODUCT STANDARD

SIZE	Outside Diameter		Inside Diameter		Bending Radius (m)	Length
	MIN	MAX	MIN	MAX		
1/4"	9.70	10.20	11.50	14.00	45	100
3/8"	12.30	12.70	15.60	6.00	50	100
1/2"	15.80	16.20	19.30	19.80	65	50
3/4"	20.70	21.10	24.30	24.90	75	50
1 1/4"	26.20	26.80	30.20	30.70	100	50
1 1/2"	34.70	35.30	39.00	39.90	125	30
2 1/2"	40.00	40.70	45.40	46.80	150	25
2"	50.80	51.60	57.00	57.60	175	20
2 1/2"	63.00	63.60	70.20	70.80	200	10
3"	78.00	78.70	85.20	85.90	225	10
4"	101.60	102.60	108.50	109.50	275	10

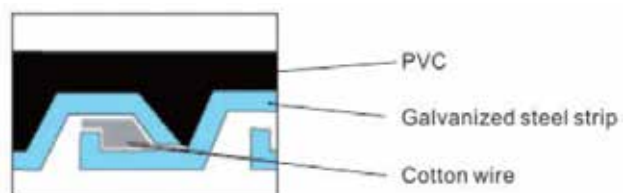

PULL BOX

CABLE DUCT

CABLE LADDER

STEEL CONDUIT

FLEXIBLE CONDUIT

CONDUIT FITTINGS

FLEXIBLE CONDUIT FITTINGS

STEEL BOX

CONDUIT BODIES

PLASTIC FITTINGS

PULICA FITTINGS





## TABLE OF PRODUCT STANDARD

SIZE	Outside Diameter		Inside Diameter		Bending Radius (m)	Length
	MIN	MAX	MIN	MAX		
1/4"	9.70	10.20	8.50	9.00	45	100
3/8"	12.50	12.70	11.60	12.00	50	100
1/2"	15.80	16.20	14.30	14.80	65	50
3/4"	20.70	21.0	19.30	19.80	75	50
1 1/4"	28.20	28.60	26.20	26.70	100	50
1 1/2"	34.70	35.30	32.00	32.60	125	30
2 1/2"	40.00	40.70	37.40	38.00	150	25
2"	50.80	51.60	47.00	47.60	175	20
2 1/2"	63.00	63.60	59.20	59.80	200	10
3"	76.00	76.70	71.20	71.90	225	10
4"	101.60	102.60	95.50	96.50	275	10

## Stainless Steel Conduit



## Pulica Tube LV-5



## TABLE OF PRODUCT STANDARD

SIZE	Outside Diameter		Inside Diameter		Bending Radius (m)	Length
	MIN	MAX	MIN	MAX		
1/4"	9.70	10.20	8.50	9.00	45	100
3/8"	12.50	12.70	11.60	12.00	50	100
1/2"	15.80	16.20	14.30	14.80	65	50
3/4"	20.70	21.0	19.30	19.80	75	50
1 1/4"	28.20	28.60	26.20	26.70	100	50
1 1/2"	34.70	35.30	32.00	32.60	125	30
2 1/2"	40.00	40.70	37.40	38.00	150	25
2"	50.80	51.60	47.00	47.60	175	20
2 1/2"	63.00	63.60	59.20	59.80	200	10
3"	76.00	76.70	71.20	71.90	225	10
4"	101.60	102.60	95.50	96.50	275	10

## Liquid Tide Conduit (JSB Type)

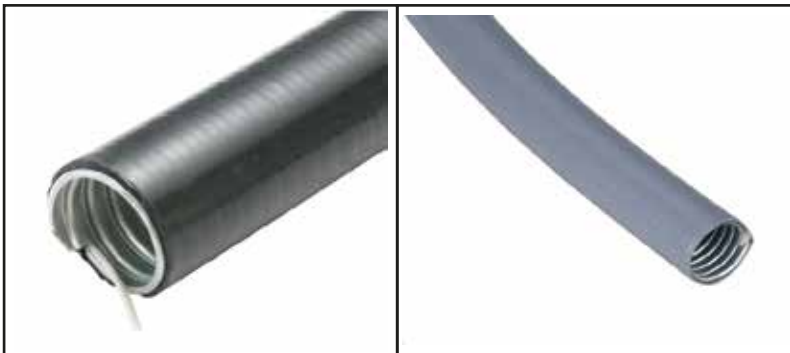

## TABLE OF PRODUCT STANDARD

SIZE	Outside Diameter		Inside Diameter		Bending Radius (m)	Length
	MIN	MAX	MIN	MAX		
1/2"	15.80	16.20	14.30	14.80	85	50
3/4"	20.70	20.70	19.30	19.80	100	50
1"	26.20	26.20	24.70	25.20	150	50
1 1/4"	34.70	34.70	32.20	32.70	180	20
1 1/2"	40.00	40.00	37.50	38.00	220	20
2"	50.80	50.80	48.30	48.80	250	20
2 1/2"	63.00	63.00	60.50	61.00	300	10
3"	76.00	76.00	73.50	74.00	450	10
4"	101.60	101.60	99.10	99.60	600	5

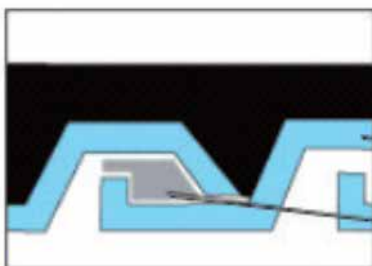

PVC

Galvanized steel strip

Cotton wire

PULL BOX

CABLE DUCT

CABLE LADDER

STEEL CONDUIT

FLEXIBLE CONDUIT

CONDUIT FITTINGS

FLEXIBLE CONDUIT FITTINGS

STEEL BOX

CONDUIT BODIES

PLASTIC FITTINGS

PULICA FITTINGS





**YASHIMA  
NBV Co.,LTD**



**EMT Rigid & IMC Conduit Fittings**

**51**

**YASHIMA  
NBV Co.,LTD**

## TABLE OF PRODUCT STANDARD

Cat#	Size
OSP-050	1/2"
OSP-075	3/4"
OSP-100	1"
OSP-125	1 1/4"
OSP-150	1 1/2"
OSP-200	2"
OSP-250	2 1/2"
OSP-300	3"
OSP-400	4"

### EMT STRAP ONE HOLE



### EMT STRAP TWO HOLE



## TABLE OF PRODUCT STANDARD

Cat#	Size
TSP-050	1/2"
TSP-075	3/4"
TSP-100	1"
TSP-125	1 1/4"
TSP-150	1 1/2"
TSP-200	2"
TSP-250	2 1/2"
TSP-300	3"
TSP-400	4"

### STRUCT CLAMP

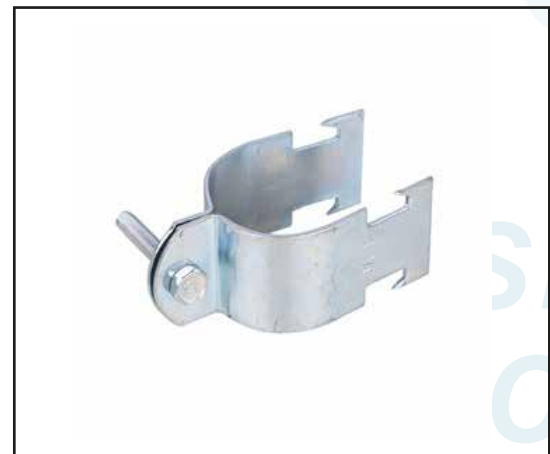

## TABLE OF PRODUCT STANDARD

Cat#	Size
SC-050	1/2"
SC-075	3/4"
SC-100	1"
SC-125	1 1/4"
SC-150	1 1/2"
SC-200	2"
SC-250	2 1/2"
SC-300	3"
SC-400	4"

PULL BOX

CABLE DUCT

CABLE LADDER

STEEL CONDUIT

FLEXIBLE CONDUIT

CONDUIT FITTINGS

FLEXIBLE CONDUIT FITTINGS

STEEL BOX

CONDUIT BODIES

PLASTIC FITTINGS

PULICA FITTINGS



## CONDUIT HANGER



## TABLE OF PRODUCT STANDARD

Cat#	Size
CH-050	1/2"
CH-075	3/4"
CH-100	1"
CH-125	1 1/4"
CH-150	1 1/2"
CH-200	2"
CH-250	2 1/2"
CH-300	3"
CH-400	4"

## TABLE OF PRODUCT STANDARD

Cat#	Size	d	d2	L
SSCN-A050	1/2"	G1/2"	18.50	29.00
SSCN-A075	3/4"	G3/4"	24.00	33.30
SSCN-A100	1"	G1"	30.00	37.00
SSCN-A125	1 1/4"	G1 1/4"	38.80	48.00
SSCN-A150	1 1/2"	G1 1/2"	45.00	51.20
SSCN-A200	2"	G2"	56.40	60.00
SSCN-A300	3"	G3"	90.00	85.00
SSCN-A400	4"	G4"	115.00	94.00

## EMT Connector Set Screw Type ALU

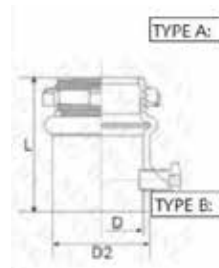

## EMT Coupling Set Screw Type ALU



## TABLE OF PRODUCT STANDARD

Cat#	Size	d	d2	L
SSCN-A050	1/2"	18.40	18.50	38.00
SSCN-A075	3/4"	24.00	24.00	43.00
SSCN-A100	1"	30.00	30.00	52.00
SSCN-A125	1 1/4"	38.80	38.80	62.00
SSCN-A150	1 1/2"	45.00	45.00	72.80
SSCN-A200	2"	56.40	56.40	87.00
SSCN-A300	3"	90.00	90.00	104.00
SSCN-A400	4"	115.00	115.00	130.00

PULL BOX

CABLE  
DUCT

CABLE  
LADDER

STEEL  
CONDUIT

FLEXIBLE  
CONDUIT

CONDUIT  
FITTINGS

FLEXIBLE  
CONDUIT  
FITTINGS

STEEL BOX

CONDUIT  
BODIES

PLASTIC  
FITTINGS

PULICA  
FITTINGS

**EMT Connector Set  
Screw Type Zinc**

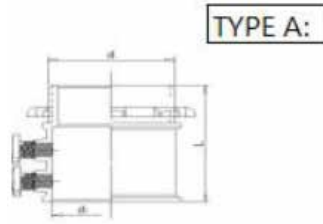

TYPE A:

**TABLE OF PRODUCT STANDARD**

Cat#	Size	d	d2	L
SSCN-A050	1/2"	NPT1/2"	18.50	29.00
SSCN-A075	3/4"	NPT3/4"	24.00	33.30
SSCN-A100	1"	NPT1"	30.00	37.00
SSCN-A125	1 1/4"	NPT1 1/4"	38.80	48.00
SSCN-A150	1 1/2"	NPT1 1/2"	45.00	51.20
SSCN-A200	2"	NPT2"	56.40	60.00
SSCN-A250	2 1/2"	NPT2 1/2"	74.00	74.00
SSCN-A300	3"	NPT3"	90.00	85.00
SSCN-A400	4"	NPT4"	115.00	94.00

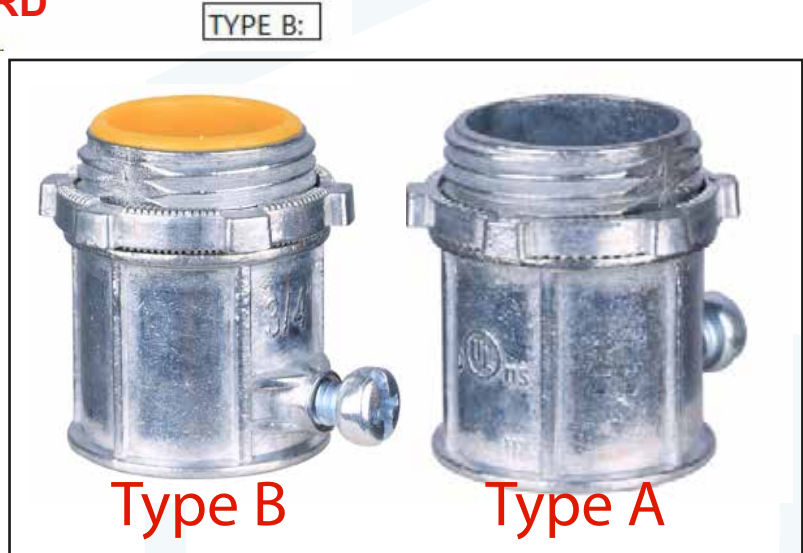

TYPE B:

Type B

Type A

**EMT Coupling Set  
Screw Type Zinc**

PULL BOX

CABLE DUCT

CABLE LADDER

STEEL CONDUIT

FLEXIBLE CONDUIT

CONDUIT FITTINGS

FLEXIBLE CONDUIT FITTINGS

STEEL BOX

CONDUIT BODIES

PLASTIC FITTINGS

PULICA FITTINGS



**TABLE OF PRODUCT STANDARD**

Cat#	Size	d1	d2	L
SSCP-Z050	1/2"	18.40	17.00	38.00
SSCP-Z075	3/4"	24.00	22.00	43.00
SSCP-Z100	1"	30.00	28.00	52.00
SSCP-Z125	1 1/4"	38.80	37.00	62.00
SSCP-Z150	1 1/2"	45.00	43.00	72.80
SSCP-Z200	2"	56.30	54.70	86.00
SSCP-Z250	2 1/2"	74.00	70.00	100.00
SSCP-Z300	3"	90.00	86.00	104.00
SSCP-Z400	4"	115.00	110.00	130.00

**EMT Connector  
Compression Type Zinc**

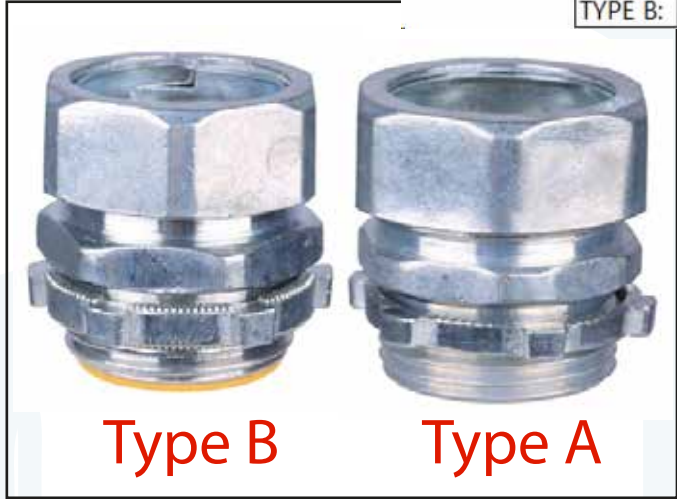
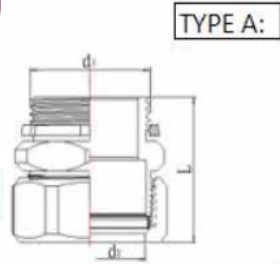
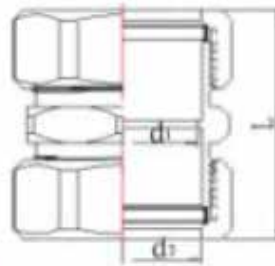

**TABLE OF PRODUCT STANDARD**

Cat#	Size	d1	d2	L
CCN-Z050	1/2"	G1/2"	18.00	35.00
CCN-Z075	3/4"	G3/4"	24.00	35.00
CCN-Z100	1"	G1"	30.00	40.00
CCN-Z125	1 1/4"	G1 1/4"	39.00	45.00
CCN-Z150	1 1/2"	G1 1/2"	45.00	50.00
CCN-200	2"	G2"	56.50	55.00

**TABLE OF PRODUCT STANDARD**

Cat#	Size	d1	d2	L
CCP-Z050	1/2"	16.00	18.00	40.00
CCP-Z075	3/4"	22.00	24.00	45.00
CCP-Z100	1"	27.00	30.00	50.00
CCP-Z125	1 1/4"	36.50	39.00	55.00
CCP-Z150	1 1/2"	41.50	45.00	60.00
CCP-200	2"	52.80	56.50	60.00



**EMT Coupling  
Compression Type Zinc**

- PULL BOX
- CABLE DUCT
- CABLE LADDER
- STEEL CONDUIT
- FLEXIBLE CONDUIT
- CONDUIT FITTINGS
- FLEXIBLE CONDUIT FITTINGS
- STEEL BOX
- CONDUIT BODIES
- PLASTIC FITTINGS
- PULICA FITTINGS

o.,LTD

**EMT Connector Set  
Screw Type Steel**

**TABLE OF PRODUCT STANDARD**

Cat#	Size	d	d2	L
SSCN-S050	1/2"	18.50	21.50	35
SSCN-S075	3/4"	24.00	27.00	39
SSCN-S100	1"	30.20	34.20	43
SSCN-S125	1 1/4"	39.00	43.00	51
SSCN-S150	1 1/2"	44.80	48.80	62
SSCN-S200	2"	56.50	60.50	77
SSCN-S250	2 1/2"	74.00	80.00	86
SSCN-S300	3"	90.50	96.50	94
SSCN-S400	4"	115.50	121.50	107

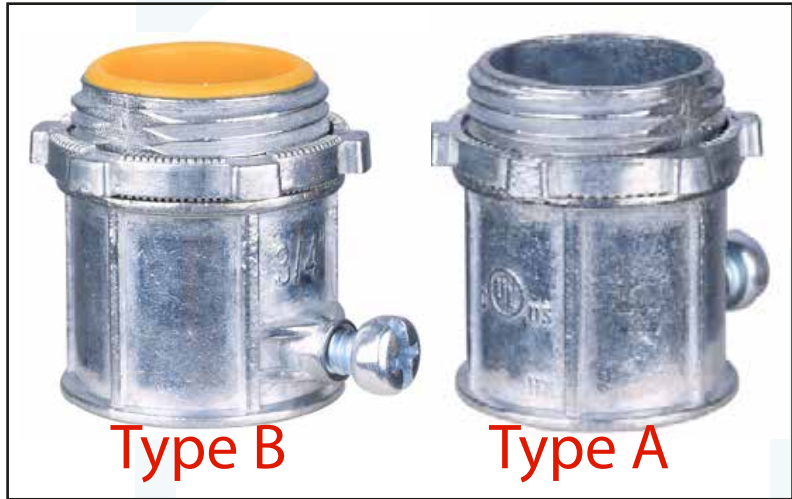
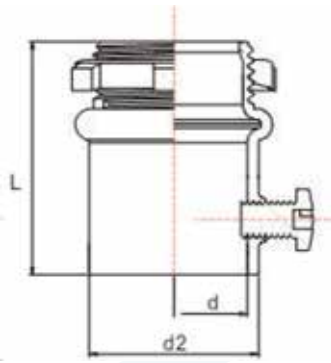

**EMT Coupling Set  
Screw Type Steel**

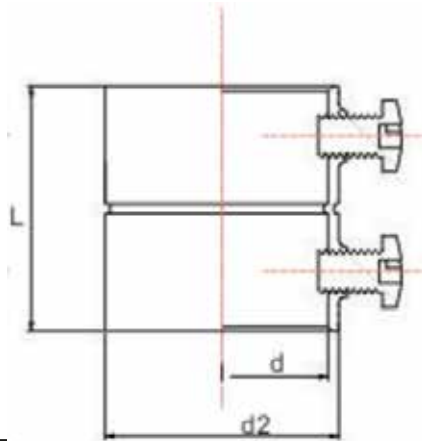

**TABLE OF PRODUCT STANDARD**

Cat#	Size	d	d2	L
SSCP-S050	1/2"	18.50	21.50	45
SSCP-S075	3/4"	24.00	27.00	63
SSCP-S100	1"	30.20	34.20	61
SSCP-S125	1 1/4"	39.00	43.00	72
SSCP-S150	1 1/2"	44.80	48.80	83
SSCP-S200	2"	56.50	60.50	95
SSCP-S250	2 1/2"	74.00	80.00	109
SSCP-S300	3"	90.50	96.50	114
SSCP-S400	4"	115.50	121.50	124

PULL BOX

CABLE DUCT

CABLE LADDER

STEEL CONDUIT

FLEXIBLE CONDUIT

CONDUIT FITTINGS

FLEXIBLE CONDUIT FITTINGS

STEEL BOX

CONDUIT BODIES

PLASTIC FITTINGS

PULICA FITTINGS

**EMT Connector  
Compression Type Steel**

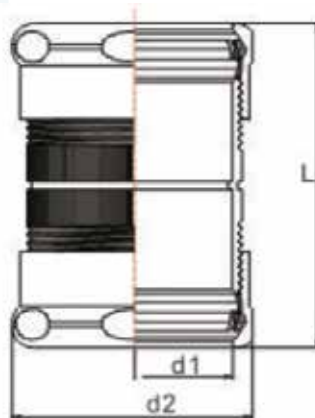

**TABLE OF PRODUCT STANDARD**

Cat#	Size	d	d2	L
CCN-S050	1/2"	18.50	27.50	46
CCN-S075	3/4"	24.00	34.50	53
CCN-S100	1"	30.20	40.50	60
CCN-S125	1 1/4"	39.00	50.00	68
CCN-S150	1 1/2"	44.80	56.50	74
CCN-S200	2"	56.50	69.00	87
CCN-S250	2 1/2"	74.00	91.50	95
CCN-S300	3"	90.50	108.50	106
CCN-S400	4"	115.50	134.50	115

**TABLE OF PRODUCT STANDARD**

Cat#	Size	d	d2	L
CCP-S050	1/2"	18.50	27.50	45
CCP-S075	3/4"	24.00	34.50	52
CCP-S100	1"	30.20	40.50	60
CCP-S125	1 1/4"	39.00	50.00	72
CCP-S150	1 1/2"	44.80	56.50	85
CCP-S200	2"	56.50	69.00	100
CCP-S250	2 1/2"	74.00	91.50	115
CCP-S300	3"	90.50	108.50	122
CCP-S400	4"	115.50	134.50	130



**EMT Coupling  
Compression Type Steel**

- PULL BOX
- CABLE DUCT
- CABLE LADDER
- STEEL CONDUIT
- FLEXIBLE CONDUIT
- CONDUIT FITTINGS
- FLEXIBLE CONDUIT FITTINGS
- STEEL BOX
- CONDUIT BODIES
- PLASTIC FITTINGS
- PULICA FITTINGS



## TABLE OF PRODUCT STANDARD

Cat#	Size
IC-050	1/2"
IC-075	3/4"
IC-100	1"
IC-125	1 1/4"
IC-150	1 1/2"
IC-200	2"
IC-250	2 1/2"
IC-300	3"
IC-400	4"

## IMC Coupling



## Reducing Bushing



## TABLE OF PRODUCT STANDARD

Cat#	Size	Cat#	Size
RB-001	3/4"->1/2"	RB-009	1-1/2"->1"
RB-002	1"->1/2"	RB-010	1-1/2"->1 1/4"
RB-003	1"->3/4"	RB-011	2"->1 1/2"
RB-004	1-1/4"->1/2"	RB-012	2"->3/4"
RB-005	1-1/4"->3/4"	RB-013	2"->1"
RB-006	1-1/4"->1"	RB-014	2"->1-1/4"
RB-007	1-1/2"->1/2"	RB-015	2"->1-1/2"
RB-008	1-1/2"->3/4"		

- PULL BOX
- CABLE DUCT
- CABLE LADDER
- STEEL CONDUIT
- FLEXIBLE CONDUIT
- CONDUIT FITTINGS
- FLEXIBLE CONDUIT FITTINGS
- STEEL BOX
- CONDUIT BODIES
- PLASTIC FITTINGS
- PULICA FITTINGS

## TABLE OF PRODUCT STANDARD

Cat#	Size	G	L	H
OSN-050	1/2"	G1/2"	10	55
OSN-075	3/4"	G3/4"	12	61
OSN-100	1"	G1"	14	69
OSN-125	1 1/4"	G1 1/4"	6	71
OSN-150	1 1/2"	G1 1/2"	18	77
OSN-200	2"	G2"	18	80

## Offser Nipples

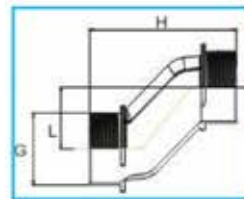

**Rigid Nipples**



**TABLE OF PRODUCT STANDARD**

Cat#	Size
RN-050	1/2"
RN-075	3/4"
RN-100	1"
RN-125	1 1/4"
RN-150	1 1/2"
RN-200	2"

**Back To Back Connector**

**TABLE OF PRODUCT STANDARD**

Cat#	Size
BB-050	1/2"
BB-075	3/4"
BB-100	1"



**Romex Connector**



**TABLE OF PRODUCT STANDARD**

Cat#	Size
RC-012	3/8"
RC-050	1/2"
RC-075	3/4"
RC-100	1"

PULL BOX

CABLE DUCT

CABLE LADDER

STEEL CONDUIT

FLEXIBLE CONDUIT

CONDUIT FITTINGS

FLEXIBLE CONDUIT FITTINGS

STEEL BOX

CONDUIT BODIES

PLASTIC FITTINGS

PULICA FITTINGS

## TABLE OF PRODUCT STANDARD

Cat#	Size	G	L
CB-050	1/2"	G1/2"	9.00
CB-075	3/4"	G3/4"	10.00
CB-100	1"	G1"	11.00
CB-125	1 1/4"	G1 1/4"	12.50
CB-150	1 1/2"	G1 1/2"	14.00
CB-200	2"	G2"	15.50

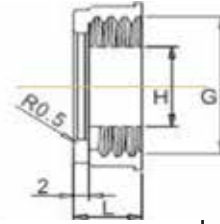

## Conduit Bushing



## Locknut ZINC DIE CASTING

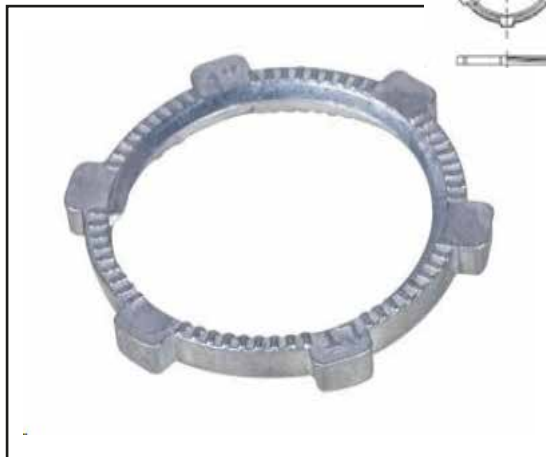

## TABLE OF PRODUCT STANDARD

Cat#	Size	D1	D2	L
LN-Z050	1/2"	G1/2"	28.30	2.90
LN-Z075	3/4"	G3/4"	24.70	3.00
LN-Z100	1"	G1"	42.40	4.00
LN-Z125	1 1/4"	G1 1/4"	54.00	4.00
LN-Z150	1 1/2"	G1 1/2"	60.00	4.00
LN-Z200	2"	G2"	75.80	4.00
LN-Z250	2 1/2"	G2 1/2"	86.60	6.50
LN-Z300	3"	G3"	103.00	6.50
LN-Z400	4"	G4"	131.00	6.50

## TABLE OF PRODUCT STANDARD

Cat#	Size	D1	D2	L
LS-Z050	1/2"	G1/2"	28.30	2.90
LS-Z075	3/4"	G3/4"	24.70	3.00
LS-Z100	1"	G1"	42.40	4.00
LS-Z125	1 1/4"	G1 1/4"	54.00	4.00
LS-Z150	1 1/2"	G1 1/2"	60.00	4.00
LS-Z200	2"	G2"	75.80	4.00
LS-Z250	2 1/2"	G2 1/2"	86.60	6.50
LS-Z300	3"	G3"	103.00	6.50
LS-Z400	4"	G4"	131.00	6.50

## Locknut Steel



- PULL BOX
- CABLE DUCT
- CABLE LADDER
- STEEL CONDUIT
- FLEXIBLE CONDUIT
- CONDUIT FITTINGS
- FLEXIBLE CONDUIT FITTINGS
- STEEL BOX
- CONDUIT BODIES
- PLASTIC FITTINGS
- PULICA FITTINGS



**YASHIMA**  
**NBV Co.,LTD**



Liquid Tight Box Connector **61**

Squeeze Connector **62**

Watertight Hub **63**

Prensa Estopa **63**

Waterproof Box Connector **64**

Ferrule **68**



**Liquid Tight Box Connector-Straight**

**TABLE OF PRODUCT STANDARD**

Cat#	Size	d1	d2	L
LTS-012	3/8"	18.50	G1/2"	17.00
LTS-050	1/2"	22.00	G1/2"	19.00
LTS-075	3/4"	27.30	G3/4"	23.30
LTS-100	1"	33.50	G1"	25.00
LTS-125	1 1/4"	45.00	G1 1/4"	34.00
LTS-150	1 1/2"	49.00	G1 1/2"	36.20
LTS-200	2"	63.00	G2"	43.00
LTS-250	2 1/2"	74.00	G2 1/2"	74.00
LTS-300	3"	91.00	G3"	85.00
LTS-400	4"	117.00	G4"	94.00

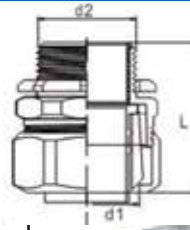

Type B

Type A

**Liquid Tight Box Connector-90° Angle**

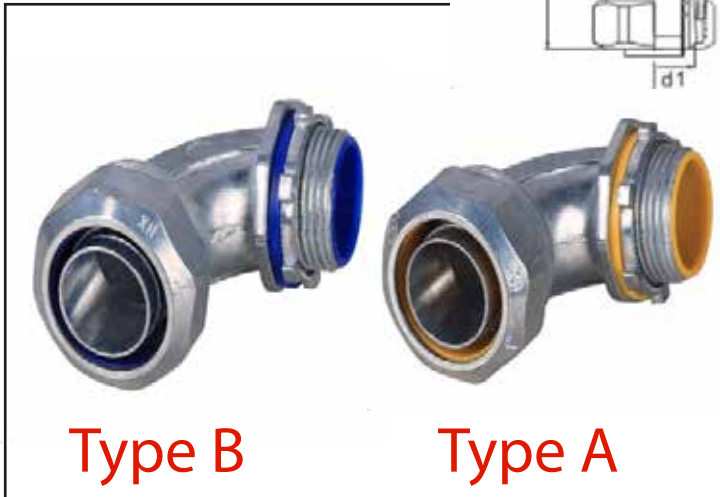
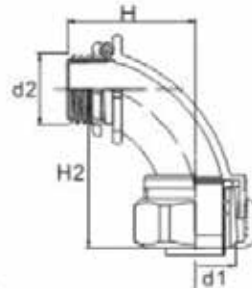

Type B

Type A

**TABLE OF PRODUCT STANDARD**

Cat#	Size	d1	d2	H	H2
LTA-012	3/8"	18.50	G1/2"	25.00	28.00
LTA-050	1/2"	22.00	G1/2"	28.00	32.00
LTA-075	3/4"	27.30	G3/4"	36.00	41.00
LTA-100	1"	33.50	G1"	40.00	44.00
LTA-125	1 1/4"	45.00	G1 1/4"	50.00	55.00
LTA-150	1 1/2"	49.00	G1 1/2"	54.00	59.00
LTA-200	2"	63.00	G2"	64.00	66.00
LTA-250	2 1/2"	74.00	G2 1/2"	70.00	77.00
LTA-300	3"	91.00	G3"	84.00	94.00
LTA-400	4"	117.00	G4"	100.00	110.00

PULL BOX

CABLE DUCT

CABLE LADDER

STEEL CONDUIT

FLEXIBLE CONDUIT

CONDUIT FITTINGS

FLEXIBLE CONDUIT FITTINGS

STEEL BOX

CONDUIT BODIES

PLASTIC FITTINGS

PULICA FITTINGS



**Squeeze Connector (BX)**

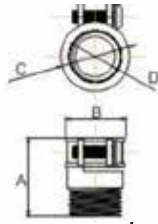
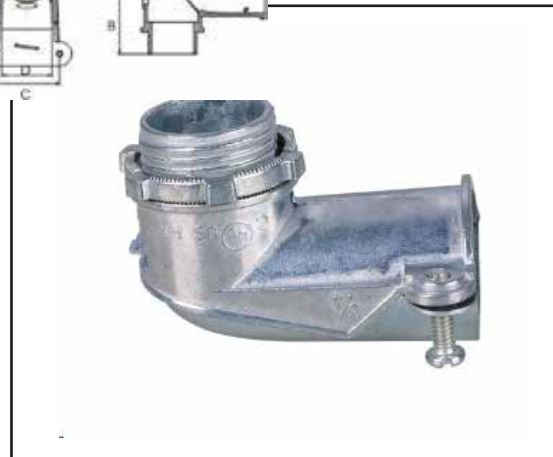
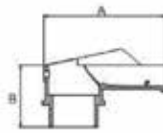
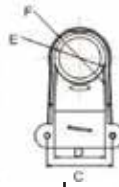

**TABLE OF PRODUCT STANDARD**



Cat#	Size	A	B	C	D
BXB-050	1/2"	30.30	28.50	26.30	16.00
BXB-075	3/4"	35.60	32.60	30.30	21.20
BXB-100	1"	38.90	40.00	37.00	27.00
BXB-125	1 1/4"	44.00	46.20	44.00	35.00
BXB-150	1 1/2"	48.50	54.20	51.20	40.60
BXB-200	2"	52.50	66.80	65.00	52.60
BXB-250	2 1/2"	71.00	84.00	81.00	64.00
BXB-300	3"	81.00	99.00	95.00	80.00
BXB-400	4"	100.00	123.00	119.00	104.00

**Squeeze Connector 90° angle**



**TABLE OF PRODUCT STANDARD**

Cat#	Size	A	B	C	D	E	F
BXA-050	1/2"	53.80	28.80	32.50	22.00	24.50	15.50
BXA-075	3/4"	59.80	29.20	38.00	27.50	30.50	20.80
BXA-100	1"	70.00	37.50	47.00	31.00	35.20	25.30
BXA-125	1 1/4"	99.00	33.00	53.00	39.50	45.80	35.50
BXA-150	1 1/2"	152.00	48.00	78.00	58.50	62.00	40.60
BXA-200	2"	152.00	48.00	78.00	58.50	65.50	52.30

PULL BOX

CABLE DUCT

CABLE LADDER

STEEL CONDUIT

FLEXIBLE CONDUIT

CONDUIT FITTINGS

FLEXIBLE CONDUIT FITTINGS

STEEL BOX

CONDUIT BODIES

PLASTIC FITTINGS

PULICA FITTINGS

## TABLE OF PRODUCT STANDARD

Cat#	Size	d1	d2	L
WHB-050	1/2"	G1/2"	21.00	35.50
WHB-075	3/4"	G3/4"	32.00	37.50
WHB-100	1"	G1"	41.00	43.50
WHB-125	1 1/4"	G1 1/4"	47.00	46.00
WHB-150	1 1/2"	G1 1/2"	56.00	46.00
WHB-200	2"	G2"	67.00	46.00
WHB-250	2 1/2"	G2 1/2"	84.00	64.00
WHB-300	3"	G3"	100.00	64.00
WHB-350	3 1/2"	G3 1/2"	113.00	64.00
WHB-400	4"	G4"	122.00	64.00

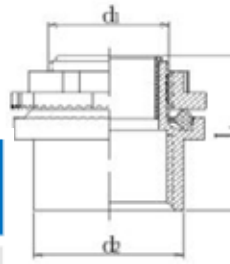

## Watertight Hub



## Prensa Estopa

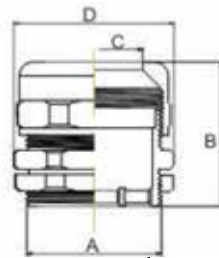

## TABLE OF PRODUCT STANDARD

Cat#	Size	A	B	C	D
PE-050	1/2"	G1/2"	31.00	12.50	23.00
PE-075	3/4"	G3/4"	35.00	18.50	30.00
PE-100	1"	G1"	43.00	22.70	36.00
PE-125	1 1/4"	G1 1/4"	50.00	30.00	47.00
PE-150	1 1/2"	G1 1/2"	51.00	32.80	52.00
PE-200	2"	G2"	53.00	45.00	64.00

PULL BOX

CABLE  
DUCTCABLE  
LADDERSTEEL  
CONDUITFLEXIBLE  
CONDUITCONDUIT  
FITTINGSFLEXIBLE  
CONDUIT  
FITTINGS

STEEL BOX

CONDUIT  
BODIESPLASTIC  
FITTINGSPULICA  
FITTINGS

**Waterproof Box Connector**

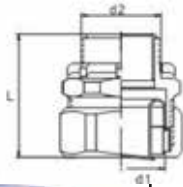

Type A

Type B

**TABLE OF PRODUCT STANDARD**

Cat#	Size	d1	d2	L
DPJ-008	1/4"	G3/8*	13.00	26
DPJ-010	5/16"	G3/8*	15.00	30
DPJ-012	3/8"	G1/2*	19.20	33
DPJ-050	1/2"	G1/2*	22.00	36
DPJ-075	3/4"	G3/4*	28.00	39
DPJ-100	1"	G1*	34.00	41
DPJ-125	1 1/4"	G1 1/4*	43.50	45
DPJ-150	1 1/2"	G1 1/2*	49.00	49
DPJ-200	2"	G2*	61.00	54
DPJ-250	2 1/2"	G2 1/2*	77.00	62
DPJ-300	3"	G3*	90.00	65
DPJ-400	4"	G4*	116.50	72
DPJ-500	5"	G5*	135.00	75
DPJ-600	6"	G6*	162.00	80

**TABLE OF PRODUCT STANDARD**

Cat#	Size	d1	d2	L
DPN-012	3/8"	19.20	G1/2*	33
DPN-050	1/2"	22.00	G1/2*	36
DPN-075	3/4"	28.00	G3/4*	39
DPN-100	1"	34.00	G1*	41
DPN-125	1 1/4"	43.50	G1 1/4*	45
DPN-150	1 1/2"	49.00	G1 1/2*	49
DPN-200	2"	61.00	G2*	54
DPN-250	2 1/2"	77.00	G2 1/2*	62
DPN-300	3"	90.00	G3*	65
DPN-400	4"	116.50	G4*	72

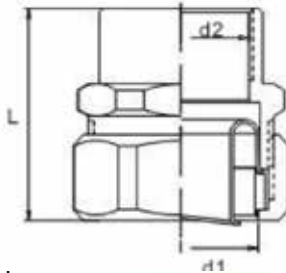

Type B

Type A

**Squeeze Connector 90° angle**

PULL BOX

CABLE DUCT

CABLE LADDER

STEEL CONDUIT

FLEXIBLE CONDUIT

CONDUIT FITTINGS

FLEXIBLE CONDUIT FITTINGS

STEEL BOX

CONDUIT BODIES

PLASTIC FITTINGS

PULICA FITTINGS

**Waterproof Pipe Connector**

**TABLE OF PRODUCT STANDARD**

Cat#	Size	d1	d2	L
DKJ-012	3/8"	19.20	19.70	31
DKJ-050	1/2"	22.00	19.70	34
DKJ-075	3/4"	28.00	26.30	38
DKJ-100	1"	34.00	32.50	42
DKJ-125	1 1/4"	43.50	33.80	46
DKJ-150	1 1/2"	49.00	52.00	48
DKJ-200	2"	61.00	64.60	53
DKJ-250	2 1/2"	77.00	76.90	62
DKJ-300	3"	90.00	9.00	65
DKJ-400	4"	116.50	116.30	72

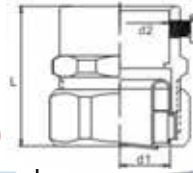

**Type A**



**Type B**

**Waterproof Box Connector Flat Type**

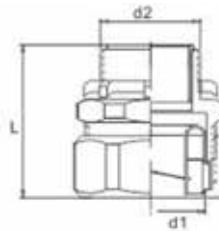

**TABLE OF PRODUCT STANDARD**

Cat#	Size	d1	d2	L
DKJ-FT-012	3/8"	19.20	18.00	31
DKJ-FT-050	1/2"	22.00	22.00	34
DKJ-FT-075	3/4"	28.00	27.40	38
DKJ-FT-100	1"	34.00	34.20	42
DKJ-FT-125	1 1/4"	43.50	43.00	46
DKJ-FT-150	1 1/2"	49.00	48.80	48
DKJ-FT-200	2"	61.00	60.60	53
DKJ-FT-250	2 1/2"	77.00	76.00	62
DKJ-FT-300	3"	90.00	92.00	65
DKJ-FT-400	4"	116.50	117.00	72

PULL BOX

CABLE DUCT

CABLE LADDER

STEEL CONDUIT

FLEXIBLE CONDUIT

CONDUIT FITTINGS

FLEXIBLE CONDUIT FITTINGS

STEEL BOX

CONDUIT BODIES

PLASTIC FITTINGS

PULICA FITTINGS

**Waterproof Box Connector 90° Angle**

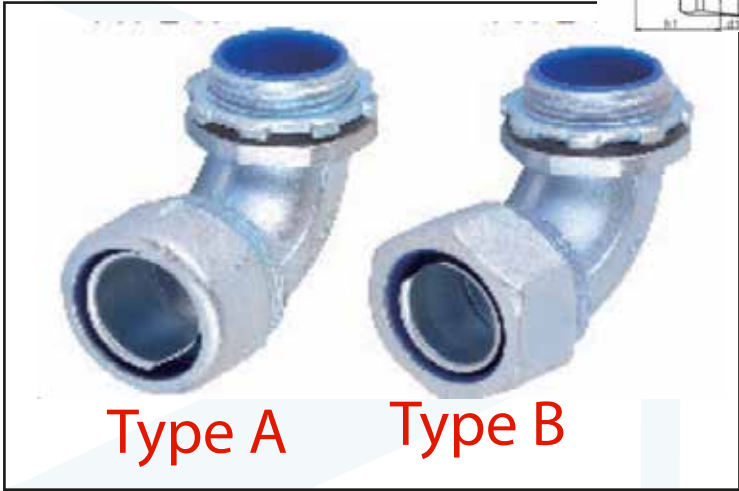
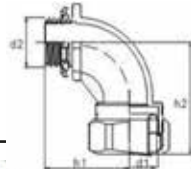

**TABLE OF PRODUCT STANDARD**

Cat#	Size	d1	d2	H	H2
90DWT-012	3/8"	19.50	G1/2"	25.00	28.00
90DWT-050	1/2"	22.50	G1/2"	28.00	32.00
90DWT-075	3/4"	28.50	G3/4"	36.00	41.00
90DWT-100	1"	35.00	G1"	40.00	44.00
90DWT-125	1 1/4"	44.00	G1 1/4"	50.00	55.00
90DWT-150	1 1/2"	50.00	G1 1/2"	54.00	59.00
90DWT-200	2"	63.00	G2"	64.00	66.00
90DWT-250	2 1/2"	78.00	G2 1/2"	70.00	77.00
90DWT-300	3"	90.00	G3"	84.00	94.00
90DWT-400	4"	116.00	G4"	100.00	110.00

**Waterproof Box Connector 45° Angle**

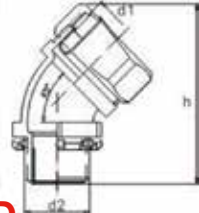

**TABLE OF PRODUCT STANDARD**

Cat#	Size	d1	d2	H	H2
45DWT-012	3/8"	19.50	G1/2"	25.00	28.00
45DWT-050	1/2"	22.50	G1/2"	28.00	32.00
45DWT-075	3/4"	28.50	G3/4"	36.00	41.00
45DWT-100	1"	35.00	G1"	40.00	44.00
45DWT-125	1 1/4"	44.00	G1 1/4"	50.00	55.00
45DWT-150	1 1/2"	50.00	G1 1/2"	54.00	59.00
45DWT-200	2"	63.00	G2"	64.00	66.00
45DWT-250	2 1/2"	78.00	G2 1/2"	70.00	77.00
45DWT-300	3"	90.00	G3"	84.00	94.00
45DWT-400	4"	116.00	G4"	100.00	110.00

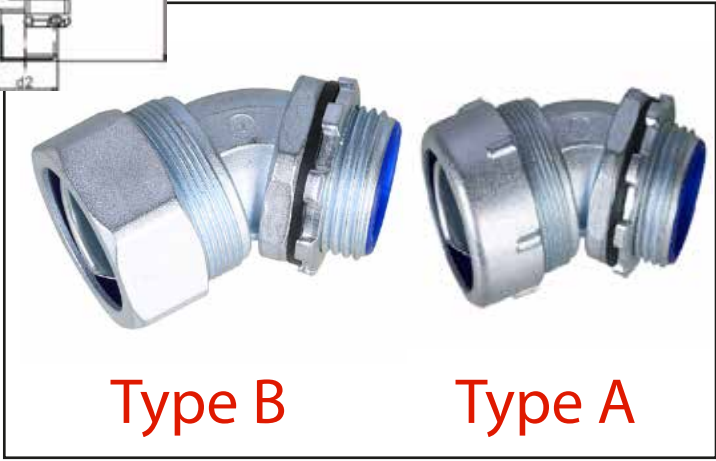

- PULL BOX
- CABLE DUCT
- CABLE LADDER
- STEEL CONDUIT
- FLEXIBLE CONDUIT
- CONDUIT FITTINGS
- FLEXIBLE CONDUIT FITTINGS
- STEEL BOX
- CONDUIT BODIES
- PLASTIC FITTINGS
- PULICA FITTINGS



**Compression Connector**

**TABLE OF PRODUCT STANDARD**

Cat#	Size	d2	S	L
DGJ-050	1/2"	22.50	30.00	47.00
DGJ-075	3/4"	28.60	37.00	50.00
DGJ-100	1"	35.30	45.00	54.00
DGJ-125	1 1/4"	44.20	53.50	62.00
DGJ-150	1 1/2"	51.00	60.00	65.00
DGJ-200	2"	63.00	74.00	65.00
DGJ-250	2 1/2"	78.00	92.00	83.00
DGJ-300	3"	90.00	110.00	83.00
DGJ-400	4"	116.00	136.00	92.00



**Flex to rigid      Flex to flex**

**Flex Connector**



**TABLE OF PRODUCT STANDARD**

Cat#	Size	D	L
FC-012	3/8"	NPT3/8"	32.00
FC-050	1/2"	NPT1/2"	35.00
CC-075	3/4"	NPT3/4"	41.00
CC-100	1"	NPT1"	49.00
CC-125	1 1/4"	NPT1 1/4"	54.00
CC-150	1 1/2"	NPT1 1/2"	59.00
CC-200	2"	NPT2"	66.00

PULL BOX

CABLE DUCT

CABLE LADDER

STEEL CONDUIT

FLEXIBLE CONDUIT

CONDUIT FITTINGS

FLEXIBLE CONDUIT FITTINGS

STEEL BOX

CONDUIT BODIES

PLASTIC FITTINGS

PULICA FITTINGS

NBV Co

**Ferrule**

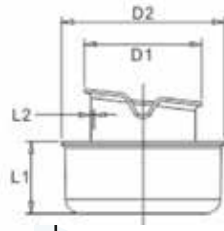

**TABLE OF PRODUCT STANDARD**

Cat#	Size	D1	D2	L1	L2
FER-008	1/4"	12.00	17.00	8.00	0.5
FER-010	5/16"	14.00	19.00	8.50	0.5
FER-012	3/8"	15.00	21.00	8.50	0.5
FER-050	1/2"	19.00	25.00	10.00	0.5
FER-075	3/4"	23.50	30.50	10.00	0.5
FER-100	1"	29.50	38.00	12.00	0.5
FER-125	1 1/4"	38.00	46.50	12.30	0.5
FER-150	1 1/2"	43.00	42.50	14.50	0.5
FER-200	2"	55.00	64.80	14.50	0.5
FER-250	2 1/2"	68.00	80.50	15.80	0.5
FER-300	3"	83.00	94.50	17.30	0.6
FER-400	4"	105.00	119.50	17.30	0.6

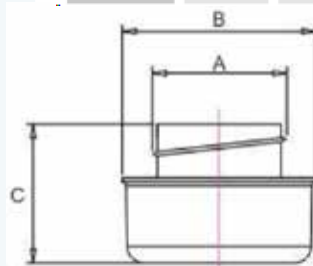

**Waterproof Box Connector 45° Angle**

**TABLE OF PRODUCT STANDARD**

Cat#	Size	A	B	C
FER-FT-050	1/2"	15.50	25.00	19.50
FER-FT-075	3/4"	21.80	31.00	20.00
FER-FT-100	1"	27.30	38.40	23.00
FER-FT-125	1 1/4"	35.30	46.00	25.80
FER-FT-150	1 1/2"	40.50	52.80	29.00
FER-FT-200	2"	52.50	65.00	28.50
FER-FT-250	2 1/2"	64.00	79.00	34.00
FER-FT-300	3"	78.00	96.00	36.00
FER-FT-400	4"	102.00	120.00	42.00



PULL BOX

CABLE DUCT

CABLE LADDER

STEEL CONDUIT

FLEXIBLE CONDUIT

CONDUIT FITTINGS

FLEXIBLE CONDUIT FITTINGS

STEEL BOX

CONDUIT BODIES

PLASTIC FITTINGS

PULICA FITTINGS



**YASHIMA  
NBV Co.,LTD**



**Steel Box**

**70**

**YASHIMA  
NBV Co., Ltd.**

### TABLE OF PRODUCT STANDARD

**52151**

**Cat# ,52151-1/2" ,3/4" ,1/2"&3/4"**

Size: 4"\*4"\*1 1/2"

Description:

1. 4"Square Steel Box

2. Thickness: 0.8mm-1.6mm

3. Material: galvanized steel



### TABLE OF PRODUCT STANDARD

**54151**

**Cat# ,54151-1/2" ,3/4" ,1/2"&3/4"**

Size: 4"\*4"\*1 1/2"

Description:

1. 4"Octagonal Box 1-1/2"deep

2. Thickness: 0.8mm-1.6mm

3. Material: galvanized steel



**58351**

### TABLE OF PRODUCT STANDARD

**Cat# ,58351-1/2" ,3/4" ,1/2"&3/4"**

Size: 4"\*2"\*1 1/2"

Description:

1. 4"\*2"Handy Steel Box

2. Thickness: 0.8mm-1.6mm

3. Material: galvanized steel



**58361**

### TABLE OF PRODUCT STANDARD

**Cat# ,58361-1/2" ,3/4" ,1/2"&3/4"**

Size: 4"\*2"\*1 7/8"

Description:

1. 4"\*2"Handy Steel Box

2. Thickness: 0.8mm-1.6mm

4. Material: galvanized steel



- PULL BOX
- CABLE DUCT
- CABLE LADDER
- STEEL CONDUIT
- FLEXIBLE CONDUIT
- CONDUIT FITTINGS
- FLEXIBLE CONDUIT FITTINGS
- STEEL BOX
- CONDUIT BODIES
- PLASTIC FITTINGS
- PULICA FITTINGS



**53151**



**TABLE OF PRODUCT STANDARD**

Cat#_53151-1/2",3/4",1/2"&3/4"
Size: 4"4"1/2"
Description:
1. 4"Square Box Without bottom
2. Thickness: 0.8mm-1.6mm
3. Knockout: Side: 12-1/2"
4. Material: galvanized steel

**52C1**



**TABLE OF PRODUCT STANDARD**

Cat#_52C1
Size: 4"4"
Description:
1. 4"Flat blank Square cover
2. Thickness: 0.8mm-1.6mm
4. Material: galvanized steel

**TABLE OF PRODUCT STANDARD**

Cat#_58C1
Size: 4"2"
Description:
1. Steel Rectangle blank cover
2. Thickness: 0.8mm-1.6mm
4. Material: galvanized steel

**58C1**



**TABLE OF PRODUCT STANDARD**

Cat#_54C6 (Oct)
Size: 4"4"
Description:
1. 4"Flat octagonal cover KO 1/2
2. Thickness: 0.8mm-1.6mm
4. Material: galvanized steel

**54C6**



PULL BOX

CABLE DUCT

CABLE LADDER

STEEL CONDUIT

FLEXIBLE CONDUIT

CONDUIT FITTINGS

FLEXIBLE CONDUIT FITTINGS

STEEL BOX

CONDUIT BODIES

PLASTIC FITTINGS

PULICA FITTINGS





**YASHIMA  
NBV Co.,LTD**



**Conduit Bodies**

**One Way Box**



**TABLE OF PRODUCT STANDARD**

Cat#	Size
OW-20	1/2"
OW-25	3/4"

**Two Way Box**



**TABLE OF PRODUCT STANDARD**

Cat#	Size
TW-20	1/2"
TW-25	3/4"

**Three Way Box**



**TABLE OF PRODUCT STANDARD**

Cat#	Size
TRW-20	1/2"
TRW-25	3/4"

**Four Way Box**



**TABLE OF PRODUCT STANDARD**

Cat#	Size
FW-20	1/2"
FW-25	3/4"

PULL BOX

CABLE DUCT

CABLE LADDER

STEEL CONDUIT

FLEXIBLE CONDUIT

CONDUIT FITTINGS

FLEXIBLE CONDUIT FITTINGS

STEEL BOX

CONDUIT BODIES

PLASTIC FITTINGS

PULICA FITTINGS

**Elbow Box**



**TABLE OF PRODUCT STANDARD**

Cat#	Size
EB-20	1/2"
EB-25	3/4"

**Tee Box**



**TABLE OF PRODUCT STANDARD**

Cat#	Size
TB-20	1/2"
TB-25	3/4"

**TABLE OF PRODUCT STANDARD**

Cat#	Size
SEC-050	1/2"
SEC-075	3/4"
SEC-100	1"
SEC-125	1 1/4"
SEC-150	1 1/2"
SEC-200	2"

**Service Entrance Cap**



**TABLE OF PRODUCT STANDARD**

Cat#	Size
LB-050	1/2"
LB-075	3/4"
LB-100	1"
LB-125	1 1/4"
LB-150	1 1/2"
LB-200	2"

**LB**



PULL BOX

CABLE DUCT

CABLE LADDER

STEEL CONDUIT

FLEXIBLE CONDUIT

CONDUIT FITTINGS

FLEXIBLE CONDUIT FITTINGS

STEEL BOX

CONDUIT BODIES

PLASTIC FITTINGS

PULICA FITTINGS

**LR**



**TABLE OF PRODUCT STANDARD**

Cat#	Size
LR-050	1/2"
LR-075	3/4"
LR-100	1"
LR-125	1 1/4"
LR-150	1 1/2"
LR-200	2"

**LL**



**TABLE OF PRODUCT STANDARD**

Cat#	Size
LL-050	1/2"
LL-075	3/4"
LL-100	1"
LL-125	1 1/4"
LL-150	1 1/2"
LL-200	2"

**TABLE OF PRODUCT STANDARD**

Cat#	Size
T-050	1/2"
T-075	3/4"
T-100	1"
T-125	1 1/4"
T-150	1 1/2"
T-200	2"

**T**



**TABLE OF PRODUCT STANDARD**

Cat#	Size
C-050	1/2"
C-075	3/4"
C-100	1"
C-125	1 1/4"
C-150	1 1/2"
C-200	2"

**C**



PULL BOX

CABLE DUCT

CABLE LADDER

STEEL CONDUIT

FLEXIBLE CONDUIT

CONDUIT FITTINGS

FLEXIBLE CONDUIT FITTINGS

STEEL BOX

CONDUIT BODIES

PLASTIC FITTINGS

PULICA FITTINGS

PLASTIC FITTINGS

Bushing



TABLE OF PRODUCT STANDARD

Cat#	Size
CB-PS050	1/2"
CB-PS075	3/4"
CB-PS100	1"
CB-PS125	1 1/4"
CB-PS150	1 1/2"
CB-PS200	2"
CB-PS250	2 1/2"
CB-PS300	3"
CB-PS350	3 1/2"
CB-PS400	4"

TABLE OF PRODUCT STANDARD

Cat#	Size
LTC-PS012	3/8"
LTC-PS050	1/2"
LTC-PS075	3/4"
LTC-PS100	1"
LTC-PS125	1 1/4"
LTC-PS150	1 1/2"
LTC-PS200	2"

Liquid Tight Box Connector-Straight



Liquid Tight Box Connector-90° Angle



TABLE OF PRODUCT STANDARD

Cat#	Size
LTA-PS012	3/8"
LTA-PS050	1/2"
LTA-PS075	3/4"
LTA-PS100	1"
LTA-PS125	1 1/4"
LTA-PS150	1 1/2"
LTA-PS200	2"

PULL BOX

CABLE DUCT

CABLE LADDER

STEEL CONDUIT

FLEXIBLE CONDUIT

CONDUIT FITTINGS

FLEXIBLE CONDUIT FITTINGS

STEEL BOX

CONDUIT BODIES

PLASTIC FITTINGS

PULICA FITTINGS



PULICA FITTING

TABLE OF PRODUCT STANDARD

Cat#	Size	D1	D2	L
WBG-17	1/2"	24.00	G1/2"	39
WBG-24	3/4"	31.00	G3/4"	40
WBG-30	1"	37.00	G1"	47
WBG-38	1 1/4"	45.80	G1 1/4"	49
WBG-50	1 1/2"	59.80	G1 1/2"	54
WBG-63	2"	72.00	G2"	59
WBG-76	2 1/2"	78.00	G2 1/2"	63
WBG-83	3"	91.00	G3"	66
WBG-101	4"	118.00	G4"	73

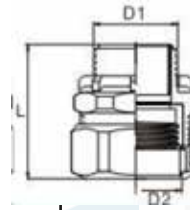

WBG

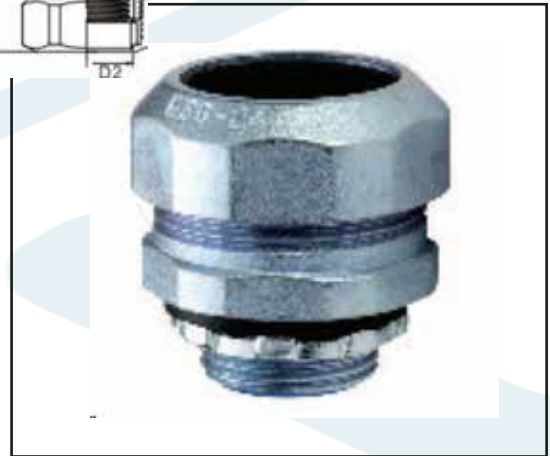

WUG

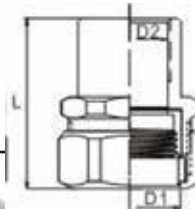
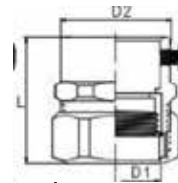

TABLE OF PRODUCT STANDARD

Cat#	Size	D1	D2	L
WUG-17	1/2"	24.00	G1/2"	35
WUG-24	3/4"	31.00	G3/4"	36
WUG-30	1"	37.00	G1"	40
WUG-38	1 1/4"	45.80	G1 1/4"	46
WUG-50	1 1/2"	59.80	G1 1/2"	46
WUG-63	2"	72.00	G2"	51
WUG-76	2 1/2"	78.00	G2 1/2"	63
WUG-83	3"	91.00	G3"	64
WUG-101	4"	118.00	G4"	72

TABLE OF PRODUCT STANDARD

Cat#	Size	D1	D2	L
NUG-17	1/2"	24.00	G1/2"	35
NUG-24	3/4"	31.00	G3/4"	36
NUG-30	1"	37.00	G1"	40
NUG-38	1 1/4"	45.80	G1 1/4"	46
NUG-50	1 1/2"	59.80	G1 1/2"	46
NUG-63	2"	72.00	G2"	51
NUG-76	2 1/2"	78.00	G2 1/2"	63
NUG-83	3"	91.00	G3"	64
NUG-101	4"	118.00	G4"	72



NUG



PULL BOX

CABLE DUCT

CABLE LADDER

STEEL CONDUIT

FLEXIBLE CONDUIT

CONDUIT FITTINGS

FLEXIBLE CONDUIT FITTINGS

STEEL BOX

CONDUIT BODIES

PLASTIC FITTINGS

PULICA FITTINGS

**WC**

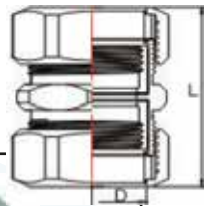
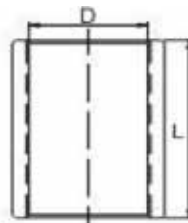

**TABLE OF PRODUCT STANDARD**

Cat#	Size	D	L
WC-17	1/2"	24	54
WC-24	3/4"	31	57
WC-30	1"	37	65
WC-38	1 1/4"	45.8	71
WC-50	1 1/2"	59.8	77
WC-63	2"	72	86
WC-76	2 1/2"	78	92
WC-83	3"	9	95
WC-101	4"	118	113

**TABLE OF PRODUCT STANDARD**

Cat#	Size	D	L
KS-17	1/2"	M28*1.5	41.5
KS-24	3/4"	M35*2	45
KS-30	1"	M43*2	49
KS-38	1 1/4"	M55*2	58
KS-50	1 1/2"	M68*2	67
KS-63	2"	M82*2	70
KS-76	2 1/2"	M87*2	74
KS-83	3"	M117*2	78
KS-101	4"	M128*2	82



**KS**



**KG**

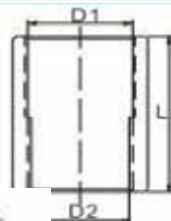

**TABLE OF PRODUCT STANDARD**

Cat#	Size	D1	D2	L
KG-17	1/2"	M28*2	M25*2	41.5
KG-24	3/4"	M35*2	M31*2	45
KG-30	1"	M43*2	M40*2	49
KG-38	1 1/4"	M55*2	M46*2	58
KG-50	1 1/2"	M68*2	M57*2	67
KG-63	2"	M82*2	M73*2	70
KG-76	2 1/2"	M87*2	M85*2	74
KG-83	3"	M117*2	M115*2	78
KG-101	4"	M128*2	M125*2	82

PULL BOX

CABLE DUCT

CABLE LADDER

STEEL CONDUIT

FLEXIBLE CONDUIT

CONDUIT FITTINGS

FLEXIBLE CONDUIT FITTINGS

STEEL BOX

CONDUIT BODIES

PLASTIC FITTINGS

PULICA FITTINGS

### TABLE OF PRODUCT STANDARD

Cat#	Size	D1	D2	L
BG-17	1/2"	M19*2	G1/2"	31
BC-24	3/4"	M28*2	G3/4"	36
BG-30	1"	M35*2	G1"	38.5
BC-38	1 1/4"	M42*2	G1 1/4"	41
BG-50	1 1/2"	M55*2	G1 1/2"	43
BG-63	2"	M70*2	G2"	52
BG-76	2 1/2"	M85*2	G2 1/2"	57
BC-83	3"	M109*2	G3"	63
BG-101	4"	M128*2	G4"	68

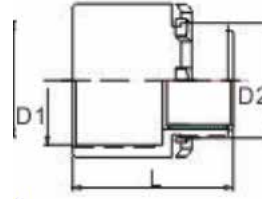

**BG**



**VKC**

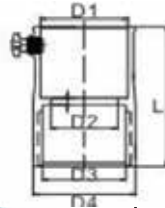

### TABLE OF PRODUCT STANDARD

Cat#	Size	D1	D2	D3	D4	L
VKC-17	1/2"	22.2	17	M21*2	26	41
VKC-24	3/4"	28.4	23.4	M28*2	33.5	44
VKC-30	1"	34.5	29.4	M34*2	41	47
VKC-38	1 1/4"	44	38	M43*2	49	55
VKC-50	1 1/2"	51	46	M54*2	61	55
VKC-63	2"	64	59	M69*2	76.5	73
VKC-76	2 1/2"	78	73	M85*2	90.5	73
VKC-83	3"	86	81	M104*2	97	73
VKC-101	4"	110	105	M128*2	124	73

### TABLE OF PRODUCT STANDARD

Cat#	Size	A	B
WAG-17	1/2"	G1/2"	24
WAG-24	3/4"	G3/4"	31
WAG-30	1"	G1"	37
WAG-38	1 1/4"	G1 1/4"	45.8
WAG-50	1 1/2"	G1 1/2"	59.8
WAG-63	2"	G2"	72

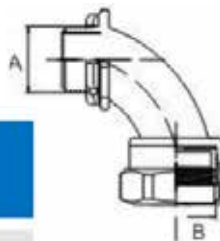

**WAG**

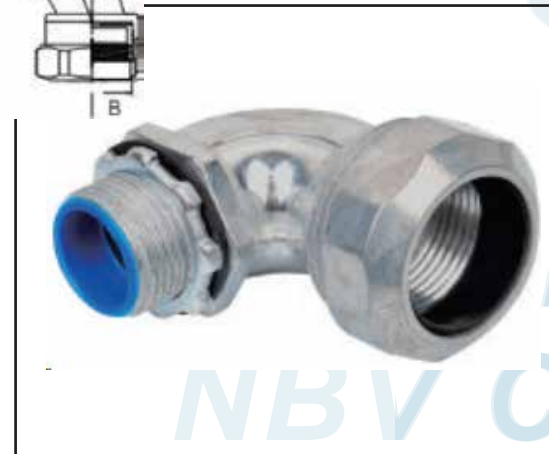

PULL BOX

CABLE DUCT

CABLE LADDER

STEEL CONDUIT

FLEXIBLE CONDUIT

CONDUIT FITTINGS

FLEXIBLE CONDUIT FITTINGS

STEEL BOX

CONDUIT BODIES

PLASTIC FITTINGS

PULICA FITTINGS



**YASHIMA**  
**Co.,LTD**

PULL BOX

CABLE  
DUCT

CABLE  
LADDER

STEEL  
CONDUIT

FLEXIBLE  
CONDUIT

CONDUIT  
FITTINGS

FLEXIBLE  
CONDUIT  
FITTINGS

STEEL BOX

CONDUIT  
BODIES

PLASTIC  
FITTINGS

PULICA  
FITTINGS

